

SPECIFICATIONS

Hunter Model 2000B

B A N D I T

Linear Amplifier

Duty Cycle.....50% Lo, 35% Med, 25% High
Max. Power Input.....2,000 watt PEP SSB
Band Coverage.....80, 40, 20, 15, & 10
Modulation.....SSB and CW
(RTTY & AM Possible)
AC Power Source.....115VAC 60 cps 20 amps
230VAC 60 cps 10 amps
Excitation Required.....100 watts minimum
Input Impedance.....50-70 ohms
Output Impedance.....50-70 ohms
VSWR.....2:1 maximum
Metering.....Relative R.F. Volts, Ep, Ip
Power Supply.....Self-contained Solid-State
Size.....7 3/4" x 14 7/8" x 13 1/4"
Tube Complement.....4--Zero Bias Triodes
Weight.....Apx. 55 Lbs.
Front Controls.....PA Tuning
Ant. Loading
Band Switch
Aux. Ant. Loading
Relative RF Output
Plate Meter
Power On-off Switch
Internal Controls.....Power Supply Tap Switch
Rear Panel Connections..Antenna Output
RF Input
Relay Control
Relay Contacts
Ground

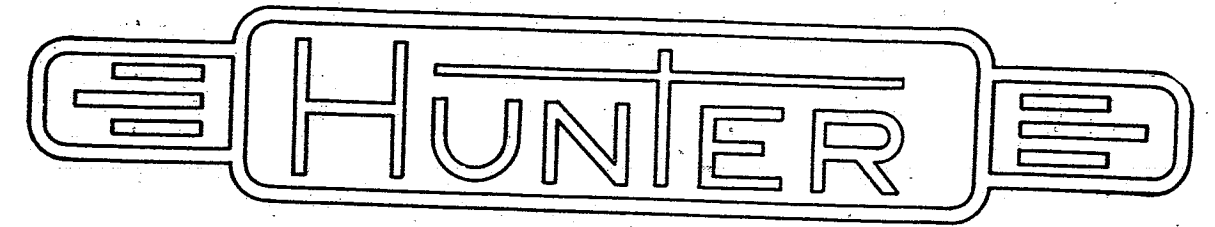

ASSEMBLY
AND
OPERATING INSTRUCTIONS



MODEL - 2000B
BANDIT
Linear Amplifier

PRICE \$2.00

PARTS LIST

The numbers in parenthesis refer to the keyed numbers on the Parts Pictorial to aid in identification.

Hunter Part Number	Description	Quantity Per Kit
RESISTORS		
22-074-9	1.2 Kohm 1w 10% Carbon	1
22-081-6	10 Kohm 1w 10% Carbon	1
22-154-3	390 Kohm 1w 1% Film	2
22-153-7	360 Kohm 1w 1% Film	2
22-110-9	82 Kohm 2w 10% Carbon	12
22-146-0	75 ohm 5w 5% NIT Wirewound	8
22-122-6	350 ohm 10w 5% NIT Wirewound	2
22-148-2	5 ohm 10w 5% Wirewound	1
22-152-1	Meter Shunt	1 (22)
11-128-2	Potentiometer 50 Kohm 2w Linear Taper	1
CAPACITORS		
12-504-2	.01 uf 1KV, Disc Ceramic	7 (38)
12-507-0	.02 uf 1KV, Disc Ceramic	2 (38)
12-550-3	1000 mmf, 5KV Transmitting Cap	2 (39)
12-547-0	140 uf VDC Electrolytic Cap	6 (37)
12-553-1	Variable, 15-353 mmf	1
554-7	E. F. Johnson 154-2-9	2
12-548-6	Variable 20-700 mmf	1
	E. F. Johnson 154-40-A	
	.0003 mmf 2500 VDC Transmitting Mica	3 (40)
MECHANICAL PARTS		
15-976-4	Main Chassis	1 (2)
15-979-2	Tube Chassis	1 (4)
15-978-0	Front Panel (Finished) 1/16"	1 (1)
15-977-6	Front Panel (Backup) 1/8"	1 (5)
15-984-7	Rear Panel	1 (6)
15-990-8	Case Mounting Block	1 (11)
15-995-8	Air Vent Cover	1 (16)
15-985-3	High Voltage Cover	1 (3)
15-982-5	'T' Channel	1 (7)
15-987-5	Switch Mounting Bracket	1 (14)
15-980-3	Fan Motor Bracket	1 (17)
15-944-2	Shorting Links	2 (12)
15-983-1	Rear Support Channel	1 (8)
15-985-5	High Voltage Cover Mount	1 (10)
15-981-9	Fan Shroud	1 (18)
15-988-1	Capacitor Mounting Standoff	1 (13)
15-922-0	Fan Assembly Standoff (1 3/4" x 1/4")	1
15-991-4	Tube Cap Standoff (5 3/8" x 1/4")	1
15-997-0	10 Point Terminal Board	2
19-002-1	Change over Board	1 (15)
002-1	Ceramic Spacer 3/8" x 1/2"	1 (20)
15-987-5	Bifilar Choke Bracket	2 (9)
19-003-7	Ceramic Spacer, Tube Cap	1 (19)
	Fan Blade	2

Hunter Part Number	Description	Quantity Per Kit
MISCELLANEOUS		
17-006-9	Rubber Feet	4
17-333-8	Aluminum Feet	2
10-501-8	Name Plate	1
17-362-7	Tinnerman Nuts	2 (36)
14-509-8	Large inlay knobs	2 (34)
14-508-2	Small inlay knobs	2 (33)
14-505-4	Single Point Knobs	3 (35)
19-511-0	Fan Motor	2 (45)
INDUCTORS		
25-523-7	Suppressor, 6t No. 16, wound on 47 ohm 2w 10% Resistor	4
25-524-3	16t No. 10 Air wound, tapped at 9t and 4t	1
25-525-9	15t No. 12 on ceramic form	1 (41)
25-526-5	RF Choke - Antran	1 (42)
25-527-1	RF Choke - National No. R100	1 (43)
25-528-7	RF Choke, Bifilar 46t No. 14 on ceramic form	1
SEMI CONDUCTORS		
Hunter Part Number		
23-515-8	Full-Wave Doubler	1 (21)
23-512-0	1N48	1
RELAYS		
21-013-0	DPDT, MK2A	2
TRANSFORMERS		
25-521-5	Bandit 2000B	1 (44)
SWITCHES		
24-534-5	Band Switch, 5 pos. 4500 VDC 30 amp	1 (28)
24-535-1	1 pole 4 pos Continuously short	1 (31)
24-536-7	2 pol 3 pos	1 (30)
24-537-3	1 pol 3 pos	1 (29)
24-538-9	AC Power Switch SPDT	1 (32)
METERS		
18-023-4	"Relative Power Output"	1
18-024-0	"Plate Volts, Plate Current"	1
LAMPS		
20-009-8	GE Type 1815	1
20-025-4	Lampholder	1
FUSES		
24-538-4	15 ampere 250 v	1
24-529-0	20 ampere 250 v	1
24-512-3	Fuse Holder	1

Hunter Part Number	Description	Quantity Per Kit
WIRE AND CABLE		
27-541-1	Line Cord, 3 Wire No. 14	1
27-545-5	Connector Cables	2
27-544-9	No. 10 Bare Wire	24"
27-511-6	No. 14 Bare Wire	18"
27-514-4	RG-58/u Coaxial Cable	15"
27-540-5	RG-213/u Coaxial Cable	15"
27-508-3	No. 20 ga High Voltage Wire	5'
27-543-3	No. 20 ga Hookup Wire	20'
27-521-1	No. 20 ga Bare Hook-up Wire	36"
27-530-0	No. 12 Insulated Hookwire	5'
MOUNTING HARDWARE		
	6-32 x 5/8 P.H.	4
	6-32 x 3/8 P.H.	30
	6-32 x 3/8 F.H.	25
	6-32 x 1/4 P.H.	20
	6-32 x 1 F.H.	6
	6-32 x 1 P.H.	2
	8-32 x 1/4 P.H.	2
	10-32 x 3/8 P.H.	4
	10-32 x 3/8 P.H.	4
	10-32 x 1/2 P.H.	1
	4-40 x 5/16 P.H.	9
	4-40 x 1/4 P.H.	2
	No. 4 Lockwashers	11
	No. 6 Lockwashers	55
	No. 8 Lockwashers	2
	No. 10 Lockwashers	4
	No. 10 x 7/8 Flat	1
	No. 4 Nuts	11
	No. 6 Nuts	55
	No. 8 Nuts	2
	No. 10 Nuts	4
	6-32 Cap Nuts	4
	No. 6 Flat Lugs	20
	No. 6 V Lugs	4
	No. 10 Ring	4
	No. 16 Ring No. 10 Hole	4
	No. 16 Ring No. 6 Hole	10
SWITCH HARDWARE		
	3/8 x 1/2 Flat	3
	3/8 L/W	4
	3/8 - 32 Nuts	4

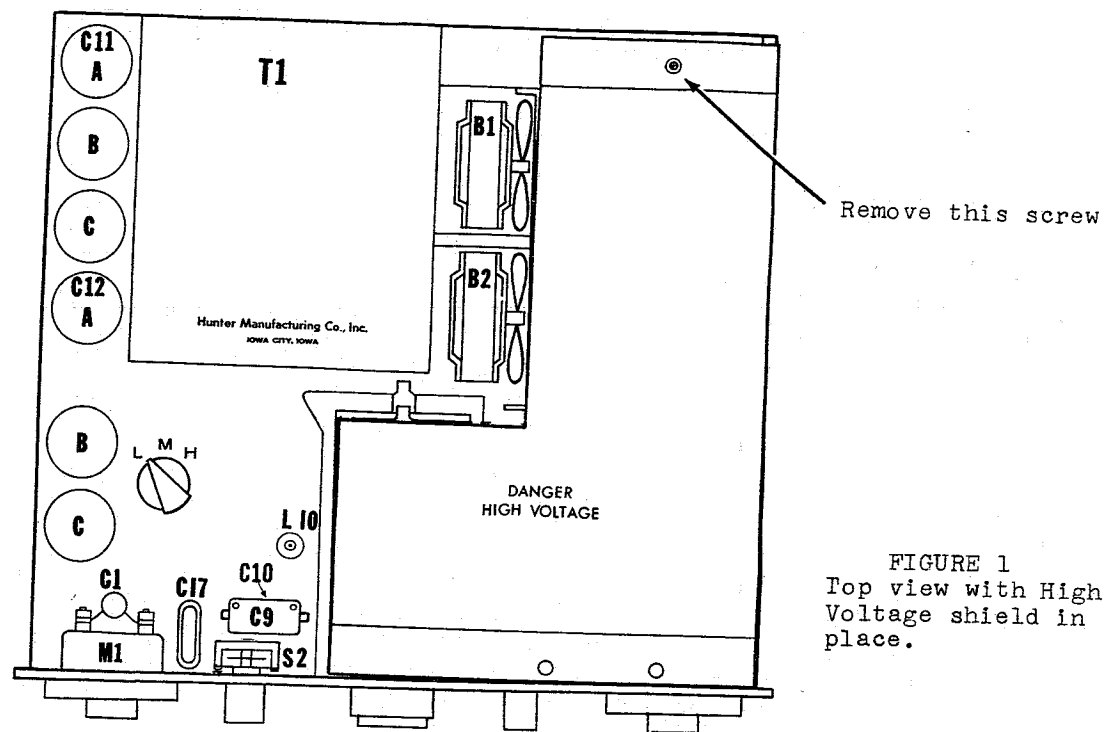

FIGURE 1
Top view with High Voltage shield in place.

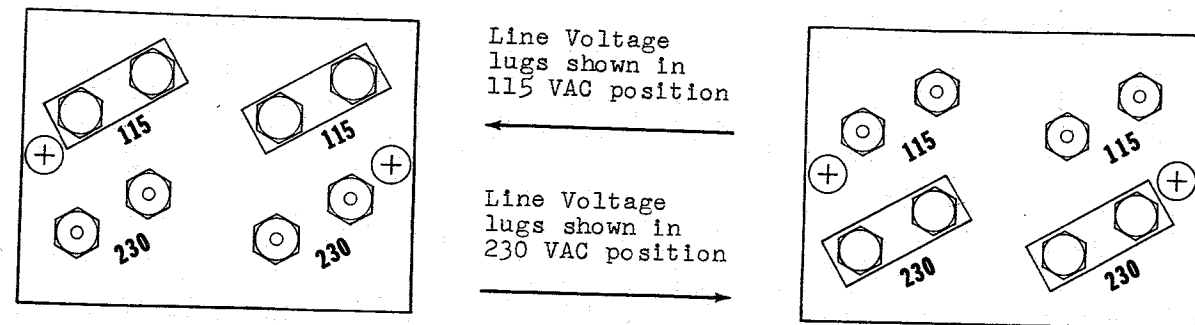

FIGURE 2

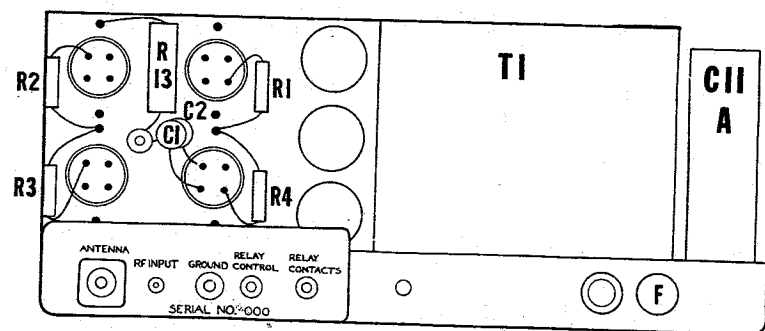

FIGURE 3 - Rear View

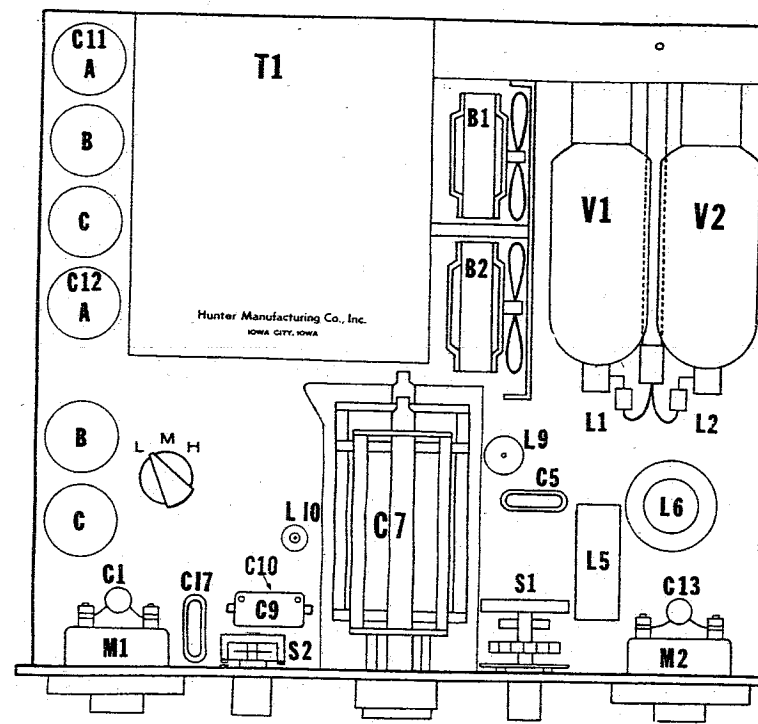

FIGURE 4
Top view with the High Voltage cover removed.

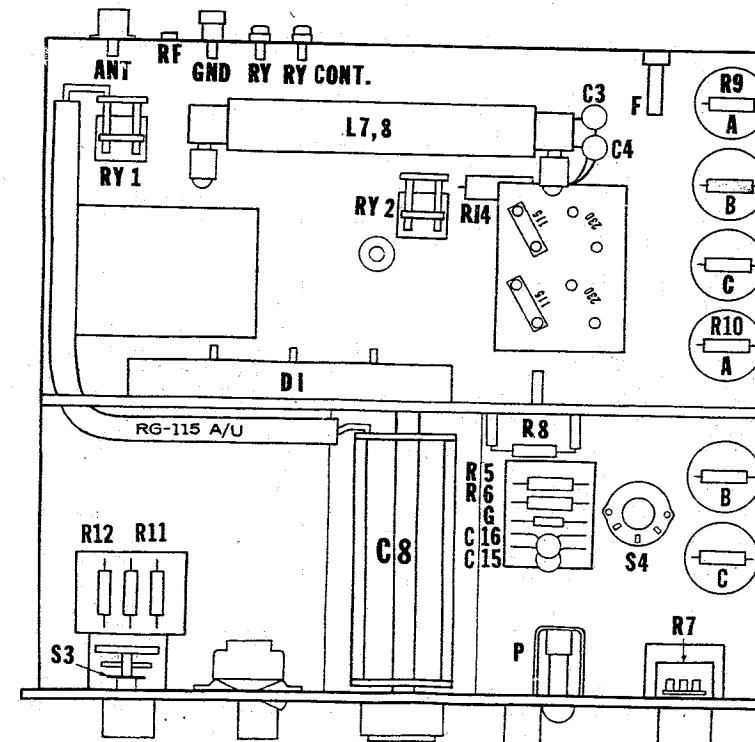
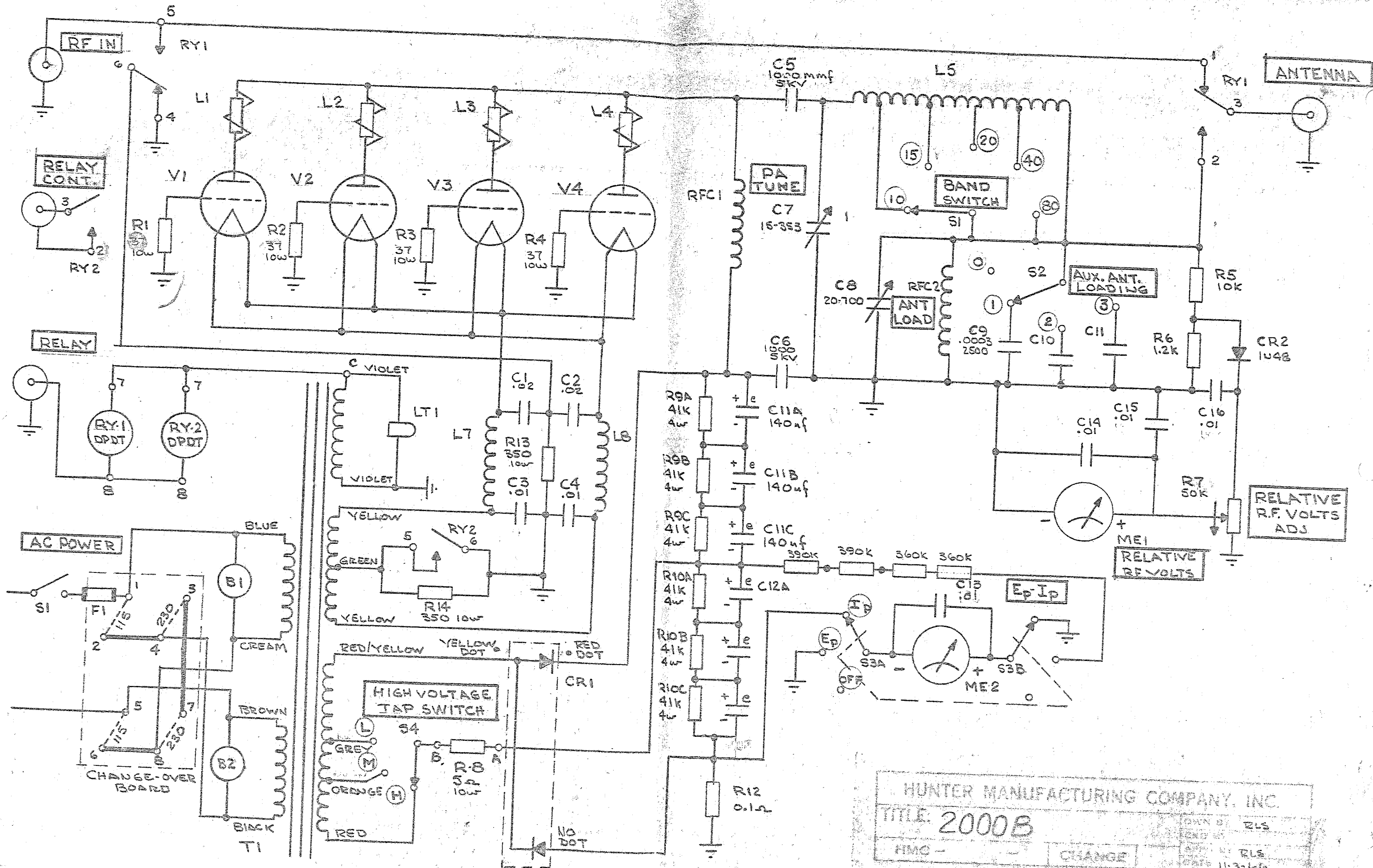

FIGURE 5
Chassis Underside

CN344
WR 67K
7385
7107



HUNTER MANUFACTURING COMPANY, INC.
 TITLE: 2000B
 HMC - CHANGE
 DATE: 11-3-66